

XPRESSION SP220

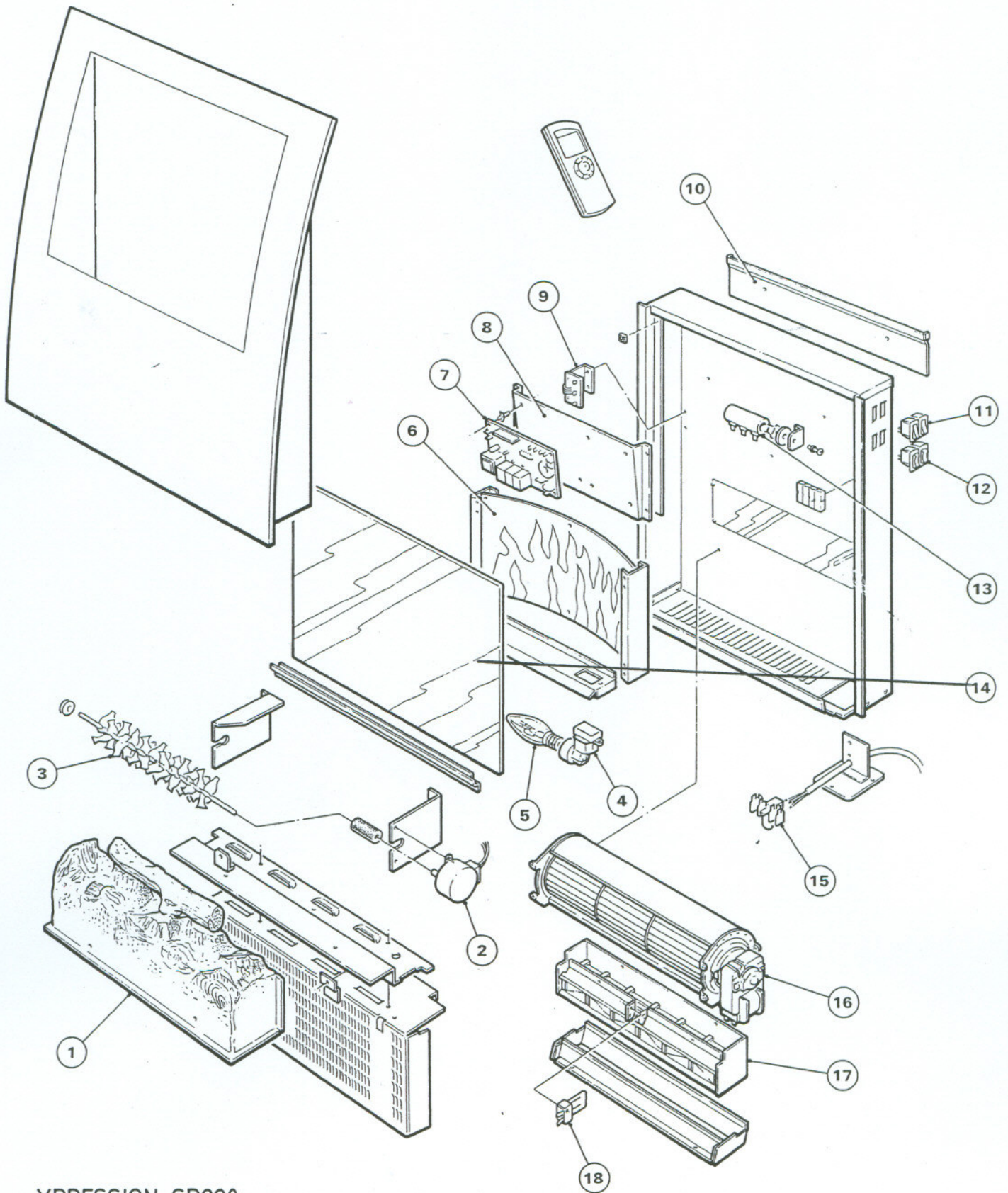

XPRESSION SP220

PARTS LIST

SMART RANGE

| ITEM | CAT NO | WATTS | VOLTS | DESCRIPTION | COLOUR | MODEL |
|------|---------|-------|-------|-----------------------|--------|-----------|
| 1 | FP03025 | | | LOG EFFECT | | SP120 |
| | FP03026 | | | LOG EFFECT | | SP220 |
| | FP03027 | | | LOG EFFECT | | SP320 |
| N/S | FP04078 | | | FUEL EFFECT | | SP820 |
| 2 | FP03020 | | | PRC 15RPM MOTOR | | |
| 3 | FP03021 | | | ROTISSERIE | | |
| 4 | FP9610 | | | LAMPHOLDER | | |
| 5 | FP03022 | 60 | | CANDLE LAMP | | |
| 6 | FP03019 | | | REFLECTOR | | |
| 7 | FP04012 | | | PCB | | SER A |
| | FP04082 | | | PCB | | SER B |
| | FP04039 | | | PCB | | SER C |
| 8 | FP03023 | | | PCB MOUNTING BRACKET | | |
| 9 | FP02033 | | | PCB SUPPORT POST | | |
| 10 | FP03028 | | | WALL BRACKET PACK | | |
| 11 | FP02035 | | | HIGH INRUSH SWITCH | | |
| 12 | BF7211 | | | SWITCH | | |
| 13 | FB9005 | | | FAN SPEED RESISTOR | | |
| 14 | FP03024 | | | REAR GLASS PANEL | | |
| 15 | BF7469 | | | TERMINAL BLOCK | | |
| 16 | FP00016 | 2000 | | BIRCH ELEMENT | | SER A - C |
| | FP03030 | 2000 | | BIRCH ELEMENT | | SER D |
| 17 | FB9003 | | | HEAT BLOWER MOTOR | | SER A - C |
| | FP03029 | | | HEAT BLOWER MOTOR | | SER D |
| 18 | FP00005 | | | CUT OUT | | |
| N/S | FP03033 | | | FRONT GLASS | | SP120 |
| N/S | FP06031 | | | FRONT GLASS INC FRAME | | SP120 |
| N/S | FP03034 | | | FRONT GLASS INC FRAME | | SP220 |
| N/S | FP03035 | | | FRONT GLASS | | SP320 |
| N/S | FP06032 | | | FRONT GLASS INC FRAME | | SP320 |
| N/S | FP04079 | | | FRONT GLASS INC FRAME | | SP820 |
| N/S | FP04015 | | | PEBBLE PACK | | SP820 |
| N/S | FP05004 | | | REMOTE | | SER A |
| N/S | FP04000 | | | REMOTE | | SER B |